



County of Riverside
DEPARTMENT OF ENVIRONMENTAL HEALTH
 www.rivcoeh.org

FOOD ESTABLISHMENT INSPECTION FORM

FACILITY NAME LA MAZORCA TORTILLERIA				DATE 1/7/2020	TIME IN 11:00 AM	TIME OUT 1:00 PM
ADDRESS 13628 MAGNOLIA AVE, Corona, CA 92879				FACILITY DESCRIPTION Not Applicable		
PERMIT HOLDER Enrique Leon				EMAIL Not Specified		Major Violations 3
PERMIT # PR0005729	EXPIRATION DATE 11/30/2019	SERVICE Routine inspection	REINSPECTION DATE Next Routine	FACILITY PHONE # (951)739-0279	PE 3611	DISTRICT 0053
INSPECTOR NAME Jason Roy					Points Deducted 25	

The conditions listed below correspond to violations of the California Health and Safety Code and/or Riverside County Ordinances and must be corrected as indicated by the enforcement officer. The Department of Environmental Health appreciates your cooperation.

Failure to correct listed violation(s) prior to the designated compliance date may necessitate an additional reinspection at a charge determined by Riverside County Ordinance 640.

Major / Minor Violations: Major Violations are those that pose an imminent risk to public health and warrant immediate closure of the food facility or immediate correction. Minor Violations are those violations that do not pose an imminent public health risk, but do warrant correction.
 GRADE REPRESENTS THE FOLLOWING RANGES: A = 100-90 Passed inspection / meets minimum health standards. B = 89-80 Did not pass inspection / does not meet minimum health standards. C = 79-0 Failed inspection / conditions exist which may pose a potential or actual threat to public health and safety. The facility is required to display a grade card in a conspicuous place selected by the Enforcement Officer. The grade card shall not be concealed and can only be removed or relocated by the Enforcement Officer per County Ordinance 492 / County Code Section 8.40.020



○ In = In compliance + COS = Corrected on-site ○ N/O = Not observed ○ N/A = Not applicable ○ OUT = Out of compliance

DEMONSTRATION OF KNOWLEDGE			COS	MAJ	OUT
In	N/A	1. Food safety certification			2
EMPLOYEE HEALTH AND HYGIENIC PRACTICES					
In		2. Communicable disease; reporting, restrictions and exclusions		4	
In	N/O	3. No persistent discharge from eyes, nose, and mouth			2
In	N/O	4. Proper eating, tasting, drinking or tobacco use			2
PREVENTING CONTAMINATION BY HANDS					
In	N/O	5. Hands clean and properly washed; gloves used properly		4	2
In		6. Adequate handwashing facilities supplied and accessible			2
TIME AND TEMPERATURE RELATIONSHIPS					
In	N/O	N/A		4	2
In	N/O	N/A		4	2
In	N/O	N/A		4	2
In	N/O	N/A		4	2
In	N/O	N/A		4	2
PROTECTION FROM CONTAMINATION					
In	N/O	N/A			2
In		13. Food: unadulterated, no spoilage, no contamination		4	2
In	N/O	N/A		4	2
		100ppm-Chlorine / 100F			

FOOD FROM APPROVED SOURCES			COS	MAJ	OUT
In		15. Food obtained from approved sources		4	2
In	N/O	N/A			2
In	N/O	N/A			2
CONFORMANCE WITH APPROVED PROCEDURES					
In		N/A			2
CONSUMER ADVISORY					
In		N/A			1
SCHOOL AND HEALTHCARE PROHIBITED FOODS					
In		N/A		4	2
WATER / HOT WATER					
In				4	2
		Water Temperature 120F@3Comp°F			
LIQUID WASTE DISPOSAL					
In				4	2
VERMIN					
In				4	2
In	N/A				1

SUPERVISION / PERSONAL CLEANLINESS	OUT
25. Person in charge present and performs duties, demonstration of knowledge	2
26. Personal cleanliness and hair restraints	1
GENERAL FOOD SAFETY REQUIREMENTS	
27. Approved thawing methods, frozen food storage	1
28. Food separated and protected from contamination	2
29. Washing fruits and vegetables	1
30. Toxic substances properly identified, stored, used	1
FOOD STORAGE / DISPLAY / SERVICE	
31. Adequate food storage; food storage containers identified	1
32. Consumer self-service	1
33. Food properly labeled; honestly presented; menu labeling	1

EQUIPMENT / UTENSILS / LINENS	OUT
34. Utensils and equipment approved, good repair	1
35. Warewashing: installed, maintained, proper use, test materials	1
36. Equipment / utensils: installed, clean, adequate capacity	1
37. Equipment, utensils, and linens: storage and use	1
38. Adequate ventilation and lighting; designated areas, use	1
39. Thermometers provided and accurate	1
40. Wiping cloths: properly used and stored	1
PHYSICAL FACILITIES	
41. Plumbing: properly installed, good repair	1
42. Refuse properly disposed; facilities maintained	1
43. Toilet facilities: properly constructed, supplied, cleaned	1
44. Premises; personal item storage and cleaning item storage	1

PERMANENT FOOD FACILITIES	OUT
45. Floors, walls, ceilings: good repair / fully enclosed	1
46. Floors, walls, and ceilings: clean	1
47. No unapproved private homes / living or sleeping quarters	1
SIGNS / REQUIREMENTS	
48. Last inspection report available	
49. Food Handler certifications available, current, and complete	1
50. Grade card and signs posted, visible	
COMPLIANCE AND ENFORCEMENT	
51. Plans approved / submitted	
52. Permit available / current	
53. Permit suspended / revoked	
54. Voluntary condemnation	
55. Impound	



County of Riverside
DEPARTMENT OF ENVIRONMENTAL HEALTH
 www.rivcoeh.org

FOOD ESTABLISHMENT INSPECTION FORM

FACILITY NAME LA MAZORCA TORTILLERIA	DATE 1/7/2020	PERMIT # PR0005729
--	-------------------------	------------------------------

1. FOOD SAFETY CERTIFICATION

POINTS
2

Inspector Comments: Provide original copy of valid Food Manager Certification by 1-14-2020. Food Manager Certification must be posted at facility for inspector review at all times.

Violation Description: Food facilities that prepare, handle or serve non-prepackaged potentially hazardous food, shall have an employee who has passed an approved food safety certification examination. Food safety certificate must be maintained at the food facility and made available for inspection. (113947.1 - 113947.5)

5. HANDS CLEAN & PROPERLY WASHED; GLOVES USED PROPERLY

⚠ CRITICAL ⚠

POINTS
4

Inspector Comments: Observed employee(cook) breaking raw shell eggs without hand washing before continuing with food preparation of ready to eat foods. All employees must practice required hand washing technique and frequency. Also, employees must discontinue using the three compartment sink for hand washing. Only designated hand wash sinks are to be used for this purpose.

Violation Description: Employees hands and exposed arms shall be kept clean, with fingernails properly trimmed. Employees are required to properly wash their hands: before handling food, equipment, or utensils; as often as necessary during food preparation, to remove soil and contamination; when switching from working with raw to ready-to-eat food; before putting on gloves and working with food; after touching body parts; after using toilet room; or any time when contamination may occur. Employees shall minimize bare hand and arm contact with non-prepackaged food that is in ready-to-eat form. Whenever gloves are worn, they shall be changed or replaced as often as handwashing is required. Approved hand sanitizer can be used in addition to proper handwashing. (113952, 113953.3, 113953.4, 113961, 113968, 113973)

7. PROPER HOT & COLD HOLDING TEMPERATURES

⚠ CRITICAL ⚠

POINTS
4

Inspector Comments: Bagged masa was measured at an internal temperature of 78F. Masa is to be maintained at 41F or below for cold holding. Pork Chicharrones were measured at an internal temperature of 64F and must be maintained at a minimum holding temperature of 135F. These food items were discarded.

Violation Description: Potentially hazardous food shall be held at or below 41°F / 45°F or at or above 135°F. Potentially hazardous food removed from proper holding temperature during preparation must be returned to proper temperature within 2 hours. Potentially hazardous food shall be received at proper temperature without evidence of temperature abuse. (113996, 113998, 114037)

13. FOOD: UNADULTERATED, NO SPOILAGE, NO CONTAMINATION

POINTS
2

Inspector Comments: Observed spoiled chicharrones stored in plastic bag. All food is to be maintained at required holding temperature and in safe condition. Food item was discarded.

Violation Description: All food shall be manufactured, produced, prepared, compounded, packed, stored, transported, kept for sale, and served to be pure and free from adulteration, spoilage, and contamination. Food shall be fully fit for human consumption. (113967, 113976, 113980, 113982, 113988, 113990, 114035, 114254.3)

23. NO RODENTS, INSECTS, BIRDS, OR ANIMALS

⚠ CRITICAL ⚠

POINTS
4

Inspector Comments: Facility has an active rodent infestation. Fresh rodent droppings observed throughout facility. Take all necessary steps to eliminate rodents including implementation of comprehensive rodent control program with exclusion survey. Provide current pest control receipts with target pests identified as rodents and roaches. Remove rodent droppings in safe manner.

Violation Description: Each food facility shall be kept free of vermin. Only approved animals, such as service animals or decorative fish in aquariums, are permitted inside a food facility. (114259.1, 114259.4, 114259.5)

24. VERMIN PROOFING, AIR CURTAINS, SELF-CLOSING DOORS

POINTS
1

Inspector Comments: Implement rodent exclusion program. This should include sealing all potential entry points into facility and eliminating outside harborage areas. remove all excess storage from inside and outside of facility. Discontinue collecting water from roof drain into plastic container. Completely clean outside of facility to eliminate rodent attractants and replaced damaged outside siding of facility. Replace back delivery door sweep.

Violation Description: Each food facility shall be constructed, equipped, maintained, and operated to prevent the entrance and harborage of animals, including birds and vermin. (114259, 114259.2, 114259.3)

28. FOOD SEPARATED AND PROTECTED FROM CONTAMINATION

POINTS
2

Inspector Comments: Store all foods at walk in refrigerator at least 6" off of the ground on approved shelving. Also, ensure all containers of food stored in refrigeration units are covered.

Violation Description: All food shall be separated and protected from contamination. (113984, 113986, 114060, 114067(a, d, e), 114069(a, d), 114073, 114077, 114089.1(c), 114143(c))



FOOD ESTABLISHMENT INSPECTION FORM

FACILITY NAME LA MAZORCA TORTILLERIA	DATE 1/7/2020	PERMIT # PR0005729
--	-------------------------	------------------------------

30. TOXIC SUBSTANCES PROPERLY IDENTIFIED, STORED, USED

POINTS
1

Inspector Comments: Do not store toxics(windex) directly next to utensils. Store in separate area.

Violation Description: All poisonous substances, detergents, bleaches, and cleaning compounds shall be stored in an approved manner which prevents contamination of food or food-contact surfaces. All poisonous or toxic substances shall be properly labeled. (114254, 114254.1, 114254.2)

34. UTENSILS AND EQUIPMENT APPROVED, GOOD REPAIR

POINTS
1

Inspector Comments: Discard all severely worn utensils including knives with broken handles and deeply scored cutting boards. Replace rusted wall mounted magnetic knife holder. Discontinue using aluminum foil as shelving liners. Eliminate all raw wood from facility. Cover all exposed electrical outlets in approved manner. Several tables throughout facility are stabilized by tiles placed beneath table legs. Repair tables.

Violation Description: All utensils and equipment shall be approved and in good repair. (114130, 114130.1-114130.6, 114132, 114133, 114137, 114175, 114177, 114257)

37. EQUIPMENT, UTENSILS, LINENS: STORAGE AND USE

POINTS
1

Inspector Comments: Discontinue storing tongs on ANSUL system. Store tongs in approved manner. Relocate trash can from directly next to meat slicer. All equipment must be protected from potential contamination.

Violation Description: Utensils and equipment shall be handled and stored in an approved manner, protected from contamination. All clean and soiled linen shall be properly stored. (114067(h), 114074, 114081, 114083, 114119, 114121, 114143(a-b), 114161, 114172, 114178, 114179, 114185, 114185.2, 114185.3, 114185.4, 114185.5)

40. WIPING CLOTHS: PROPERLY USED AND STORED

POINTS
1

Inspector Comments: Store all soiled linens in buckets with approved sanitizer at required concentration.

Violation Description: Wiping cloths used to clean food spills shall be used only once, unless stored in an approved concentration of sanitizer solution and laundered daily. (114135, 114185.1, 114185.3(d-e))

44. PREMISES; PERSONAL ITEM STORAGE AND CLEANING ITEM STORAGE

POINTS
1

Inspector Comments: Relocate personals(aprons) from food/utensil storage to separate area.

Violation Description: Lockers or another approved area for personal belongings shall be provided. The premises of each food facility shall be kept clean and free of litter and items that are unnecessary to the operation or maintenance of the facility. At least one janitorial sink with hot and cold running water shall be provided. Cleaning supplies and equipment shall be stored separate from food and food-related areas. Mops shall be stored in such a way that allows air-drying. (114123, 114256, 114256.1, 114256.2, 114256.4, 114257.1, 114279, 114281, 114282)

45. FLOORS, WALLS, CEILING: GOOD REPAIR / FULLY ENCLOSED

POINTS
1

Inspector Comments: Replace all broken cove tiles throughout facility in approved manner. Replace severely deteriorated floor tile behind meat display case. Ceiling throughout facility is in a severe state of disrepair. Major water damage has caused mold growth on various area of ceiling. Peeling plater and water bubbles have formed. Roof must be repaired immediately and repair invoices provided. Failure to comply may result in facility enclosure.

Violation Description: The floors, walls, ceilings finishes must be of an approved material, durable, smooth, nonabsorbent, and easily cleanable. Food facilities shall be fully enclosed. (114143 (d), 114257, 114266, 114268, 114271, 114272)



County of Riverside
DEPARTMENT OF ENVIRONMENTAL HEALTH
www.rivcoeh.org

FOOD ESTABLISHMENT INSPECTION FORM

FACILITY NAME LA MAZORCA TORTILLERIA	DATE 1/7/2020	PERMIT # PR0005729
---	------------------	-----------------------

Overall Inspection Comments

This facility has failed to meet the minimum standards established by the Health and Safety Code. "A" card removed, "B" card posted. Facility was previously on suspension. An administrative hearing is hereby scheduled for 1-14-2020(see administrative hearing form). Facility may be subject to placement back on suspension. Graded re-inspection date will be determined at office hearing.

Did you know that effective January 1, 2018, the California Health and Safety Code was amended to make it easier for food facilities to donate food? Please consider donating your excess food product to a local food bank, pantry, or soup kitchen. As a good faith food donor, you are protected from civil and criminal liability if the food product later causes harm to its recipient, unless the injury is a direct result of gross negligence or intentional misconduct in the preparation or handling of the donated food. See Section 171425 of the Civil Code and Sections 114432 to 114434 inclusive of the Health and Safety Code. For more information visit our website at www.rivcoeh.org.

Signature

Jesse Kang
Person in Charge
01/07/2020

Jason Roy
Environmental Health Specialist
01/07/2020

REASONS FOR IMMEDIATE CLOSURE OF A FOOD FACILITY

Per California Health and Safety Code Section 114409 (a):
 "If any imminent health hazard is found, unless the hazard is immediately corrected, an enforcement officer may temporarily suspend the permit and order the food facility immediately closed."

A food facility may be closed for any of the following reasons:

- Overflowing sewage (inside or outside the facility)
- No potable water
- No hot water
- No electricity
- Rodent or insect infestation
- Any other conditions at the facility that may create an imminent public health risk

In addition to the reasons above, Per California Health and Safety Code Section 114411:

"The enforcement agency may, after providing opportunity for a hearing, modify, suspend, or revoke a permit for serious or repeated violations of any requirement of this part or for interference in the performance of the duty of the enforcement officer."

PROPER FOOD STORAGE IN REFRIGERATORS AND FREEZERS

Ready-to-Eat Food

Cooked Food

Raw Meat, Raw Eggs

Store cooked and ready-to-eat food above raw food to avoid cross-contamination. Keep all food covered to prevent contamination.

MANUAL SANITIZING OF EQUIPMENT AND UTENSILS USING A THREE COMPARTMENT SINK

1. **SCRAPE**, clean, or soak items as necessary before washing.
2. **WASH** items in detergent and hot water of at least 100°F in the first sink.
3. **RINSE** items in clear water in the second sink.
4. **SANITIZE** by submerging each item in a sanitizing solution in the third sink. Use one of the following sanitizing methods:
 - 100ppm of a chlorine based sanitizer for a minimum of 30 seconds in the solution
 - 200ppm of a quaternary ammonium based sanitizer for a minimum of 60 seconds in the solution
 - 25ppm of an iodine based sanitizer for a minimum of 60 seconds in the solution
 - Water at a temperature of 171°F for a minimum of 30 seconds in solution
5. **AIR DRY** all items on the drain board.

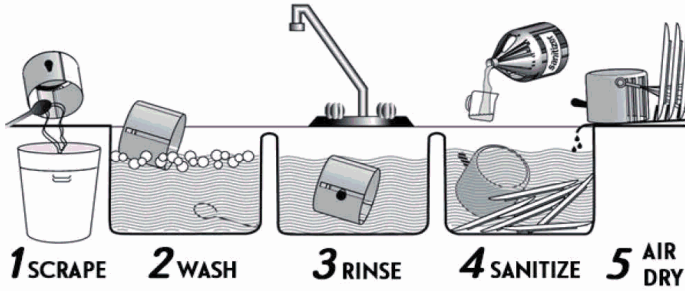

PROPER COOLING OF FOOD IN YOUR FACILITY

Potentially hazardous foods should always be rapidly cooled.

TIME IS THE KEY FACTOR IN PROPER COOLING

- Foods must cool from 135°F to 70°F in 2 hours or less
- Foods must cool from 70°F to 41°F in 4 hours or less

Use one of the following methods to cool food properly:

- Break large foods down into smaller portions and place in shallow pans no more than 4 inches deep. Metal pans cool better than glass or plastic pans.
- Add ice as an ingredient to replace water used in the recipe.
- Place foods within an ice bath and frequently stir the foods to speed the cooling process.
- Loosely cover foods so that heat and steam can escape during cooling.
- Arrange containers within a refrigeration unit so that air can flow properly around containers.
- Use special equipment like chill paddles or blast chillers to rapidly bring down food temperature.

Use an accurate thermometer to verify the food is being cooled within proper timeframes.

PROPER FOOD THAWING METHODS

1. Under refrigeration
2. In a microwave oven on "defrost"
3. Submerged under cold running water in an approved preparation sink for no longer than 2 hours
4. As part of the cooking process

INTERNAL COOKING TEMPERATURES

Use a probe thermometer to take internal cooking temperatures

135°F for 15 seconds	145°F for 15 seconds	145°F for 15 seconds	145°F for 15 seconds	155°F for 15 seconds	155°F for 15 seconds	165°F for 15 seconds	165°F for 15 seconds

Food temperature cannot be felt - use your probe thermometer!

FOOD ALLERGENS

THE MAJOR 8

FOR QUESTIONS OR COMMENTS CONTACT YOUR LOCAL AREA OFFICE

BLYTE 260 N Broadway Blythe, CA 92225 Phone 760-921-5090 Fax 760-921-5085	CORONA 2275 S Main St #204 Corona, CA 92882 Phone 951-273-9140 Fax 951-520-8319	HEMET 800 S Sanderson Ave #200 Hemet, CA 92545 Phone 951-766-2824 Fax 951-766-7874	INDIO 47-950 Arabia St #A Indio, CA 92201 Phone 760-863-8287 Fax 760-863-8303	MURRIETA 30135 Technology Dr #250 Murrieta, CA 92563 Phone 951-461-0284 Fax 951-461-0245	PALM SPRINGS 554 S Paseo Dorotea Palm Springs, CA 92264 Phone 760-320-1048 Fax 760-320-1470	RIVERSIDE 4065 County Circle Dr #104 Riverside, CA 92503 Phone 951-358-5172 Fax 951-358-5017
--	--	---	--	---	--	---