



County of Riverside
DEPARTMENT OF ENVIRONMENTAL HEALTH
 www.rivcoeh.org

FOOD ESTABLISHMENT INSPECTION FORM

FACILITY NAME SIZZLER FAMILY STEAK HOUSE				DATE 5/6/2021	TIME IN 1:30 PM	TIME OUT 3:50 PM
ADDRESS 25035 SUNNYMEAD BLVD, Moreno Valley, CA 92553				FACILITY DESCRIPTION Not Applicable		
PERMIT HOLDER B.M.W. Mgmt %Tax & License				EMAIL sizzler671@bmwmanagement.c		Major Violations 2
PERMIT # PR0003112	EXPIRATION DATE 08/31/2021	SERVICE Routine inspection	REINSPECTION DATE Next Routine	FACILITY PHONE # Not Captured	PE 3622	DISTRICT 0017
INSPECTOR NAME Brittany Whitney					Points Deducted 17	

The conditions listed below correspond to violations of the California Health and Safety Code and/or Riverside County Ordinances and must be corrected as indicated by the enforcement officer. The Department of Environmental Health appreciates your cooperation.

Failure to correct listed violation(s) prior to the designated compliance date may necessitate an additional reinspection at a charge determined by Riverside County Ordinance 640.

Major / Minor Violations: Major Violations are those that pose an imminent risk to public health and warrant immediate closure of the food facility or immediate correction. Minor Violations are those violations that do not pose an imminent public health risk, but do warrant correction.
 GRADE REPRESENTS THE FOLLOWING RANGES: A = 100-90 Passed inspection / meets minimum health standards. B = 89-80 Did not pass inspection / does not meet minimum health standards. C = 79-0 Failed inspection / conditions exist which may pose a potential or actual threat to public health and safety. The facility is required to display a grade card in a conspicuous place selected by the Enforcement Officer. The grade card shall not be concealed and can only be removed or relocated by the Enforcement Officer per County Ordinance 492 / County Code Section 8.40.020

B
SCORE 83

○ In = In compliance
+ COS = Corrected on-site
○ N/O = Not observed
○ N/A = Not applicable
○ OUT = Out of compliance

DEMONSTRATION OF KNOWLEDGE			COS	MAJ	OUT
In	N/A	1. Food safety certification Ramon Robles Serve Safe 3/21/22.			2
EMPLOYEE HEALTH AND HYGIENIC PRACTICES					
In		2. Communicable disease; reporting, restrictions and exclusions		4	
In	N/O	3. No persistent discharge from eyes, nose, and mouth			2
In	N/O	4. Proper eating, tasting, drinking or tobacco use			2
PREVENTING CONTAMINATION BY HANDS					
In	N/O	5. Hands clean and properly washed; gloves used properly		4	2
In		6. Adequate handwashing facilities supplied and accessible			2
TIME AND TEMPERATURE RELATIONSHIPS					
In	N/O	7. Proper hot and cold holding temperatures	+	4	2
In	N/O	8. Time as a public health control; procedures and records		4	2
In	N/O	9. Proper cooling methods		4	2
In	N/O	10. Proper cooking time and temperature		4	2
In	N/O	11. Proper reheating procedures for hot holding		4	
PROTECTION FROM CONTAMINATION					
In	N/O	12. Returned and re-service of food			2
In		13. Food: unadulterated, no spoilage, no contamination		4	2
In	N/O	14. Food contact surfaces: clean and sanitized	+	4	2
		Measured 10ppm Cl / Measured 150F			

FOOD FROM APPROVED SOURCES			COS	MAJ	OUT
In		15. Food obtained from approved sources		4	2
In	N/O	16. Compliance with shell stock tags, condition, display	N/A		2
In	N/O	17. Compliance with Gulf Oyster regulations	N/A		2
CONFORMANCE WITH APPROVED PROCEDURES					
In		18. Compliance with variance, specialized process, and HACCP plan	N/A		2
CONSUMER ADVISORY					
In	N/A	19. Written disclosure and reminder statements provided for raw or undercooked foods			1
SCHOOL AND HEALTHCARE PROHIBITED FOODS					
In		20. Licensed health care facilities / public and private schools; prohibited foods not offered	N/A	4	2
WATER / HOT WATER					
In		21. Hot and cold water available		4	2
		Water Temperature 3-comp 135F°F			
LIQUID WASTE DISPOSAL					
In		22. Sewage and wastewater properly disposed		4	2
VERMIN					
In		23. No rodents, insects, birds, or animals		4	2
In	N/A	24. Vermin proofing, air curtains, self-closing doors			1

SUPERVISION / PERSONAL CLEANLINESS	OUT
25. Person in charge present and performs duties, demonstration of knowledge	2
26. Personal cleanliness and hair restraints	1
GENERAL FOOD SAFETY REQUIREMENTS	
27. Approved thawing methods, frozen food storage	1
28. Food separated and protected from contamination	2
29. Washing fruits and vegetables	1
30. Toxic substances properly identified, stored, used	1
FOOD STORAGE / DISPLAY / SERVICE	
31. Adequate food storage; food storage containers identified	1
32. Consumer self-service	1
33. Food properly labeled; honestly presented; menu labeling	1

EQUIPMENT / UTENSILS / LINENS	OUT
34. Utensils and equipment approved, good repair	1
35. Warewashing: installed, maintained, proper use, test materials	1
36. Equipment / utensils: installed, clean, adequate capacity	1
37. Equipment, utensils, and linens: storage and use	1
38. Adequate ventilation and lighting; designated areas, use	1
39. Thermometers provided and accurate	1
40. Wiping cloths: properly used and stored	1
PHYSICAL FACILITIES	
41. Plumbing: properly installed, good repair	1
42. Refuse properly disposed; facilities maintained	1
43. Toilet facilities: properly constructed, supplied, cleaned	1
44. Premises; personal item storage and cleaning item storage	1

PERMANENT FOOD FACILITIES	OUT
45. Floors, walls, ceilings: good repair / fully enclosed	1
46. Floors, walls, and ceilings: clean	1
47. No unapproved private homes / living or sleeping quarters	1
SIGNS / REQUIREMENTS	
48. Last inspection report available	
49. Food Handler certifications available, current, and complete	1
50. Grade card and signs posted, visible	
COMPLIANCE AND ENFORCEMENT	
51. Plans approved / submitted	
52. Permit available / current	
53. Permit suspended / revoked	
54. Voluntary condemnation	2
55. Impound	2



County of Riverside
DEPARTMENT OF ENVIRONMENTAL HEALTH
 www.rivcoeh.org

FOOD ESTABLISHMENT INSPECTION FORM

FACILITY NAME SIZZLER FAMILY STEAK HOUSE	DATE 5/6/2021	PERMIT # PR0003112
--	-------------------------	------------------------------

7. PROPER HOT & COLD HOLDING TEMPERATURES **⚠ CRITICAL ⚠**

POINTS
4

Inspector Comments: Measured the following items inside cold top /cold drawer unit at cookline measuring 50F-60F:

- 1) Container of Sliced cheese
- 2) Several cooked ribs
- 3) several bags of cooked noodles
- 4) metal insert of marinara sauce
- 5) metal insert of butter lemon sauce
- 6) metal insert of cut cherry tomatoes
- 7) container of cooked asparagus
- 8) Several bags of cooked rice
- 9) Several bags of cooked onion
- 10) Several bags of cooked mashed potatoes
- 11) Several bags of cooked sweet potato

These items were inside unit for approximately 2.5 hours prior to temperature taken. Employee placed items into walk-in cooler for rapid cooling. Measured items at end of inspection at 30F.

Measured the following items inside cold top salad unit at 44F-50F:

- 1) Several plastic containers of ranch dressing
- 2) Metal insert of shredded parmesan cheese

These items were placed inside unit approximately 1 hour prior to temperature taken.

- 3) Two metal containers of sour cream
- 4) Two metal containers of whipped butter.

These items were placed inside unit the day prior to inspection and were voluntarily discarded at this time.

Measured the following items inside cold top unit adjacent to grill and fryers:

- 1) Sliced tomatoes at 54F
- 2) Thousand island dressing at 55F
- 3) Dressing made with mayonnaise at 53F

Measured the following soups inside hot holding unit adjacent to salad prep area:

- 1) Broccoli cheddar soup at 130F
- 2) Clam chowder at 129F
- 3) Vegetable beef soup at 129F

Employee stated items are reheated to 165F and placed in hot holding unit and items were placed inside 1 hour prior to temperature taken. Inspector instructed employee to reheat soup to 165F at this time. Measured soup at 173F inside hot holding unit.

Measured the following inside single door Beverage air cooler adjacent to warewash area at 40F-47F:

- 1) Cooked spicy mongolian beef BAO
- 2) BBQ pork BAO
- 3) Teriyaki chicken BAO
- 4) Cooked teriyaki chicken topping
- 5) Spicy kung pao chicken topping

Employee stated items were placed inside unit approximately 3 hours prior to temperature taken. Items were placed into walk-in cooler for rapid cooling. Measured items at 30F at end of inspection.

Ensure all potentially hazardous food is maintained at proper holding temperature at all times.

Violation Description: Potentially hazardous food shall be held at or below 41#F / 45#F or at or above 135#F. Potentially hazardous food removed from proper holding temperature during preparation must be returned to proper temperature within 2 hours. Potentially hazardous food shall be received at proper temperature without evidence of temperature abuse. (113996, 113998, 114037)

14. FOOD CONTACT SURFACES; CLEAN AND SANITIZED **⚠ CRITICAL ⚠**

POINTS
4

Inspector Comments: Measured 10ppm Cl sanitizer solution on dishes coming out of dishwasher during active warewashing. Person in charge noticed sanitizer bucket was low and changed sanitizer bucket for a new one. Measured 50ppm Cl sanitizer solution on dish at this time. Ensure employees are checking sanitizer solution on dish surface frequently to ensure proper warewashing procedure is being conducted.

Violation Description: All food contact surfaces of utensils and equipment shall be properly cleaned and sanitized. Food contact surfaces shall be clean to the sight and touch, no accumulation of dust, dirt, food residue, and other debris. (114097, 114099.1, 114099.2, 114099.4, 114099.6, 114099.7, 114101(b-d), 114105, 114109, 114111, 114113, 114115, 114117, 114118, 114123, 114125(b), 114130.2, 114130.5, 114141)



FOOD ESTABLISHMENT INSPECTION FORM

FACILITY NAME SIZZLER FAMILY STEAK HOUSE	DATE 5/6/2021	PERMIT # PR0003112
--	-------------------------	------------------------------

25. PERSON IN CHARGE PRESENT AND PERFORM DUTIES; DEMONSTRATION OF KNOWLEDGE

POINTS

2

Inspector Comments: Person in charge was asked how to wash equipment in 3-compartment sink. Person in charge was unable to answer the minimum wash water temperature. Person in charge also stated dishes are submerged into quat sanitizer solution for 30 seconds. Education given at this time. Ensure employees and person in charge is knowledgeable about food safety as it relates to their job duties.

Violation Description: A person in charge shall be present at the food facility during all hours of operation. The person in charge and all food employees shall have adequate knowledge and shall be trained in food safety as it relates to their assigned duties. The person in charge shall have adequate knowledge of major food allergens and must provide education to employees. (113945-113945.1, 113947, 113947.1(b)(2), 113984.1, 114075)

28. FOOD SEPARATED AND PROTECTED FROM CONTAMINATION

POINTS

2

Inspector Comments: Observed the following:

- 1) Food stored below first shelf in reach in freezer without lid or covering. Ensure all food stored below first shelf have a lid or covering to prevent any possible contamination.

- 2) New soda syrup boxes stored on shelf below mops and equipment in enclosed dumpster area. Discontinue storing food in this manner and store all food inside and protected from vermin or contamination.

- 3) Old beer kegs stored inside dumpster area. Discontinue storing equipment in dumpster area.

Violation Description: All food shall be separated and protected from contamination. (113984, 113986, 114060, 114067(a, d, e), 114069(a, d), 114073, 114077, 114089.1(c), 114143(c))

31. ADEQUATE FOOD STORAGE; FOOD STORAGE CONTAINERS IDENTIFIED

POINTS

1

Inspector Comments: Observed bowl of caesar salad placed on top of inserts inside salad bar cold top unit. Properly store food in an approved manner to ensure proper holding temperature.

Violation Description: Food shall be stored in approved containers and labeled as to contents. Food shall be stored at least 6" above the floor on approved shelving. (114047, 114049, 114051, 114053, 114055, 114067(h), 114069(b))

34. UTENSILS AND EQUIPMENT APPROVED, GOOD REPAIR

POINTS

1

Inspector Comments: Observed the following:

- 1) Cold top unit/ cold drawer unit at cookline holding 50F-60F
 - 2) Cold top unit adjacent to grill and fryer at 40F-55F
 - 3) Salad bar cold top unit holding at 44F-50F
 - 4) Single door Beverage air reach-in cooler at 46F
- Equipment has been impounded and not approved for use until repaired and verified by a member of this department.

Observed severely worn cutting board at cookline cold top unit. Repair/ replace cutting board in an approved manner.

Violation Description: All utensils and equipment shall be approved and in good repair. (114130, 114130.1-114130.6, 114132, 114133, 114137, 114175, 114177, 114257)

36. EQUIPMENT / UTENSILS PROPERLY INSTALLED, CLEAN; ADEQUATE CAPACITY

POINTS

1

Inspector Comments: Observed an accumulation of food debris and residue inside and on outside of microwaves throughout facility.

Observed an accumulation of food debris inside hot holding drawer containing cooked potatoes.

All equipment and utensils shall be kept clean and free of an accumulation of dust, dirt, food residue, and other debris.

Violation Description: All utensils and equipment shall be clean and installed in an approved manner. Equipment type and quantity shall be adequate for the operation. (114115, 114130.3, 114139, 114153, 114163, 114165, 114167, 114169, 114175, 114180, 114182, 114257)



FOOD ESTABLISHMENT INSPECTION FORM

FACILITY NAME SIZZLER FAMILY STEAK HOUSE	DATE 5/6/2021	PERMIT # PR0003112
--	-------------------------	------------------------------

37. EQUIPMENT, UTENSILS, LINENS: STORAGE AND USE

POINTS

1

Inspector Comments: Observed scoops for whipped butter stored in soiled water at 127F. If storing utensil inside water, water shall be maintained at 135F or above. Instructed person in charge to change water at this time.

Violation Description: Utensils and equipment shall be handled and stored in an approved manner, protected from contamination. All clean and soiled linen shall be properly stored. (114067(h), 114074, 114081, 114083, 114119, 114121, 114143(a-b), 114161, 114172, 114178, 114179, 114185, 114185.2, 114185.3, 114185.4, 114185.5)

44. PREMISES; PERSONAL ITEM STORAGE AND CLEANING ITEM STORAGE

POINTS

1

Inspector Comments: Measured a plate of food that was stored on top of microwave at 88F. Employee stated the plate of food was her breakfast from the morning. Store all personal items in lockers or other approved designated area.

Violation Description: Lockers or another approved area for personal belongings shall be provided. The premises of each food facility shall be kept clean and free of litter and items that are unnecessary to the operation or maintenance of the facility. At least one janitorial sink with hot and cold running water shall be provided. Cleaning supplies and equipment shall be stored separate from food and food-related areas. Mops shall be stored in such a way that allows air-drying. (114123, 114256, 114256.1, 114256.2, 114256.4, 114257.1, 114279, 114281, 114282)

54. VOLUNTARY CONDEMNATION

POINTS

0

Inspector Comments: See violation #7

Violation Description: I, as the person in charge, hereby voluntarily agree to the condemnation and destruction of the food(s) listed in this report, said food(s) being alleged unfit for human consumption and in violation of California Health and Safety Code, Section 113980. I hereby release the County of Riverside, Department of Environmental Health and authorized agents from any and all responsibility.

55. IMPOUND

POINTS

0

Inspector Comments: See violation #34

Violation Description: Use impounded equipment or food may result in legal action. Removal of the impound tag is an interference with the performance of an Enforcement Officer's duties and an unlawful act per California Health and Safety Code, Section 114393.

84. COVID 19 - FOLLOWING STATE OF CALIFORNIA GUIDELINES

POINTS

0

Inspector Comments: Observed in compliance with Industry Guidance.



County of Riverside
DEPARTMENT OF ENVIRONMENTAL HEALTH
www.rivcoeh.org

FOOD ESTABLISHMENT INSPECTION FORM

FACILITY NAME SIZZLER FAMILY STEAK HOUSE	DATE 5/6/2021	PERMIT # PR0003112
---	------------------	-----------------------

Overall Inspection Comments

This facility has failed to meet the minimum sanitation requirements of the California Health and Safety Code (83 = B). Due to repeated failed inspections within a two year period an Administrative Hearing will be (held at 800 S. Sanderson, suite 200 on 5/13/21 at 2:00pm). "B" card posted, do not move, remove or block placards to avoid penalty. "A" card removed. "B" card must remain posted until removed by an employee of this Department. If you have any questions contact Brittany at (951) 766-2824. No signature captured due to pandemic, inspection report emailed to Tony.quintero@bmwmanagement.com on 5/6/21.

Did you know that effective January 1, 2018, the California Health and Safety Code was amended to make it easier for food facilities to donate food? Please consider donating your excess food product to a local food bank, pantry, or soup kitchen. As a good faith food donor, you are protected from civil and criminal liability if the food product later causes harm to its recipient, unless the injury is a direct result of gross negligence or intentional misconduct in the preparation or handling of the donated food. See Section 171425 of the Civil Code and Sections 114432 to 114434 inclusive of the Health and Safety Code. For more information visit our website at www.rivcoeh.org.

Signature

Edward
Person in Charge
05/06/2021

Brittany Whitney
Environmental Health Specialist
05/06/2021

REASONS FOR IMMEDIATE CLOSURE OF A FOOD FACILITY

Per California Health and Safety Code Section 114409 (a):
 "If any imminent health hazard is found, unless the hazard is immediately corrected, an enforcement officer may temporarily suspend the permit and order the food facility immediately closed."

A food facility may be closed for any of the following reasons:

- Overflowing sewage (inside or outside the facility)
- No potable water
- No hot water
- No electricity
- Rodent or insect infestation
- Any other conditions at the facility that may create an imminent public health risk

In addition to the reasons above, Per California Health and Safety Code Section 114411:

"The enforcement agency may, after providing opportunity for a hearing, modify, suspend, or revoke a permit for serious or repeated violations of any requirement of this part or for interference in the performance of the duty of the enforcement officer."

PROPER FOOD STORAGE IN REFRIGERATORS AND FREEZERS

Ready-to-Eat Food

Cooked Food

Raw Meat, Raw Eggs

Store cooked and ready-to-eat food above raw food to avoid cross-contamination. Keep all food covered to prevent contamination.

MANUAL SANITIZING OF EQUIPMENT AND UTENSILS USING A THREE COMPARTMENT SINK

1. **SCRAPE**, clean, or soak items as necessary before washing.
2. **WASH** items in detergent and hot water of at least 100°F in the first sink.
3. **RINSE** items in clear water in the second sink.
4. **SANITIZE** by submerging each item in a sanitizing solution in the third sink. Use one of the following sanitizing methods:
 - 100ppm of a chlorine based sanitizer for a minimum of 30 seconds in the solution
 - 200ppm of a quaternary ammonium based sanitizer for a minimum of 60 seconds in the solution
 - 25ppm of an iodine based sanitizer for a minimum of 60 seconds in the solution
 - Water at a temperature of 171°F for a minimum of 30 seconds in solution
5. **AIR DRY** all items on the drain board.

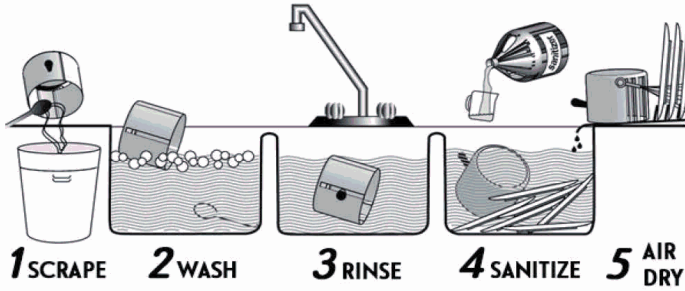

PROPER COOLING OF FOOD IN YOUR FACILITY

Potentially hazardous foods should always be rapidly cooled.

TIME IS THE KEY FACTOR IN PROPER COOLING

- Foods must cool from 135°F to 70°F in 2 hours or less
- Foods must cool from 70°F to 41°F in 4 hours or less

Use one of the following methods to cool food properly:

- Break large foods down into smaller portions and place in shallow pans no more than 4 inches deep. Metal pans cool better than glass or plastic pans.
- Add ice as an ingredient to replace water used in the recipe.
- Place foods within an ice bath and frequently stir the foods to speed the cooling process.
- Loosely cover foods so that heat and steam can escape during cooling.
- Arrange containers within a refrigeration unit so that air can flow properly around containers.
- Use special equipment like chill paddles or blast chillers to rapidly bring down food temperature.

Use an accurate thermometer to verify the food is being cooled within proper timeframes.

PROPER FOOD THAWING METHODS

1. Under refrigeration
2. In a microwave oven on "defrost"
3. Submerged under cold running water in an approved preparation sink for no longer than 2 hours
4. As part of the cooking process

INTERNAL COOKING TEMPERATURES

Use a probe thermometer to take internal cooking temperatures

135°F for 15 seconds	145°F for 15 seconds	145°F for 15 seconds	145°F for 15 seconds	155°F for 15 seconds	155°F for 15 seconds	165°F for 15 seconds	165°F for 15 seconds

Food temperature cannot be felt - use your probe thermometer!

FOOD ALLERGENS

THE MAJOR 8

FOR QUESTIONS OR COMMENTS CONTACT YOUR LOCAL AREA OFFICE

BLYTE 260 N Broadway Blythe, CA 92225 Phone 760-921-5090 Fax 760-921-5085	CORONA 2275 S Main St #204 Corona, CA 92882 Phone 951-273-9140 Fax 951-520-8319	HEMET 800 S Sanderson Ave #200 Hemet, CA 92545 Phone 951-766-2824 Fax 951-766-7874	INDIO 47-950 Arabia St #A Indio, CA 92201 Phone 760-863-8287 Fax 760-863-8303	MURRIETA 30135 Technology Dr #250 Murrieta, CA 92563 Phone 951-461-0284 Fax 951-461-0245	PALM SPRINGS 554 S Paseo Dorotea Palm Springs, CA 92264 Phone 760-320-1048 Fax 760-320-1470	RIVERSIDE 4065 County Circle Dr #104 Riverside, CA 92503 Phone 951-358-5172 Fax 951-358-5017
--	--	---	--	---	--	---