



**County of Riverside**  
**DEPARTMENT OF ENVIRONMENTAL HEALTH**  
 www.rivcoeh.org

**FOOD ESTABLISHMENT INSPECTION FORM**

FACILITY NAME <b>CANTO DE LAS SIRENAS</b>				DATE 6/20/2019	TIME IN 9:30 AM	TIME OUT 11:10 AM
ADDRESS 2055 N PERRIS Blvd E-3, Perris, CA 92571				FACILITY DESCRIPTION Not Applicable		
PERMIT HOLDER Vidal Perez				EMAIL JR-P85@yahoo.com		Major Violations 1
PERMIT # PR0072176	EXPIRATION DATE 02/28/2020	SERVICE Follow-up inspection	REINSPECTION DATE Next Routine	FACILITY PHONE # (714)800-0730	PE 3621	DISTRICT 0014
					INSPECTOR NAME Marcie Craighead	Points Deducted 9

The conditions listed below correspond to violations of the California Health and Safety Code and/or Riverside County Ordinances and must be corrected as indicated by the enforcement officer. The Department of Environmental Health appreciates your cooperation.

Failure to correct listed violation(s) prior to the designated compliance date may necessitate an additional reinspection at a charge determined by Riverside County Ordinance 640.

**Major / Minor Violations:** Major Violations are those that pose an imminent risk to public health and warrant immediate closure of the food facility or immediate correction. Minor Violations are those violations that do not pose an imminent public health risk, but do warrant correction.  
 GRADE REPRESENTS THE FOLLOWING RANGES: A = 100-90 Passed inspection / meets minimum health standards. B = 89-80 Did not pass inspection / does not meet minimum health standards. C = 79-0 Failed inspection / conditions exist which may pose a potential or actual threat to public health and safety. The facility is required to display a grade card in a conspicuous place selected by the Enforcement Officer. The grade card shall not be concealed and can only be removed or relocated by the Enforcement Officer per County Ordinance 492 / County Code Section 8.40.020

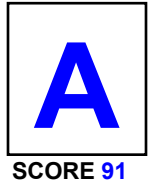

○ In = In compliance      + COS = Corrected on-site      ○ N/O = Not observed      ○ N/A = Not applicable      ○ OUT = Out of compliance

DEMONSTRATION OF KNOWLEDGE		COS	MAJ	OUT
<span style="color: green;">○</span> In	N/A 1. Food safety certification			2
EMPLOYEE HEALTH AND HYGIENIC PRACTICES				
In	2. Communicable disease; reporting, restrictions and exclusions		4	
In	N/O 3. No persistent discharge from eyes, nose, and mouth			2
In	N/O 4. Proper eating, tasting, drinking or tobacco use			2
PREVENTING CONTAMINATION BY HANDS				
In	N/O 5. Hands clean and properly washed; gloves used properly		4	2
<span style="color: green;">○</span> In	6. Adequate handwashing facilities supplied and accessible			2
TIME AND TEMPERATURE RELATIONSHIPS				
In	N/O N/A 7. Proper hot and cold holding temperatures		4	2
In	N/O N/A 8. Time as a public health control; procedures and records		4	2
In	N/O N/A 9. Proper cooling methods		4	2
In	N/O N/A 10. Proper cooking time and temperature		4	2
In	N/O N/A 11. Proper reheating procedures for hot holding		4	
PROTECTION FROM CONTAMINATION				
In	N/O N/A 12. Returned and re-service of food			2
In	13. Food: unadulterated, no spoilage, no contamination		4	2
In	N/O N/A 14. Food contact surfaces: clean and sanitized		4	2

FOOD FROM APPROVED SOURCES		COS	MAJ	OUT
In	15. Food obtained from approved sources		4	2
In	N/O N/A 16. Compliance with shell stock tags, condition, display			2
In	N/O N/A 17. Compliance with Gulf Oyster regulations			2
CONFORMANCE WITH APPROVED PROCEDURES				
In	N/A 18. Compliance with variance, specialized process, and HACCP plan			2
CONSUMER ADVISORY				
In	N/A 19. Written disclosure and reminder statements provided for raw or undercooked foods			1
SCHOOL AND HEALTHCARE PROHIBITED FOODS				
In	N/A 20. Licensed health care facilities / public and private schools; prohibited foods not offered		4	2
WATER / HOT WATER				
In	21. Hot and cold water available		4	2
Water Temperature °F				
LIQUID WASTE DISPOSAL				
In	22. Sewage and wastewater properly disposed		4	2
VERMIN				
In	23. No rodents, insects, birds, or animals		4	2
In	N/A 24. Vermin proofing, air curtains, self-closing doors			1

SUPERVISION / PERSONAL CLEANLINESS	OUT
25. Person in charge present and performs duties, demonstration of knowledge	2
26. Personal cleanliness and hair restraints	1
GENERAL FOOD SAFETY REQUIREMENTS	
27. Approved thawing methods, frozen food storage	1
28. Food separated and protected from contamination	2
29. Washing fruits and vegetables	1
30. Toxic substances properly identified, stored, used	1
FOOD STORAGE / DISPLAY / SERVICE	
31. Adequate food storage; food storage containers identified	1
32. Consumer self-service	1
33. Food properly labeled; honestly presented; menu labeling	1

EQUIPMENT / UTENSILS / LINENS	OUT
34. Utensils and equipment approved, good repair	1
35. Warewashing: installed, maintained, proper use, test materials	1
36. Equipment / utensils: installed, clean, adequate capacity	1
37. Equipment, utensils, and linens: storage and use	1
38. Adequate ventilation and lighting; designated areas, use	1
39. Thermometers provided and accurate	1
40. Wiping cloths: properly used and stored	1
PHYSICAL FACILITIES	
41. Plumbing: properly installed, good repair	1
42. Refuse properly disposed; facilities maintained	1
43. Toilet facilities: properly constructed, supplied, cleaned	1
44. Premises; personal item storage and cleaning item storage	1

PERMANENT FOOD FACILITIES	OUT
45. Floors, walls, ceilings: good repair / fully enclosed	1
46. Floors, walls, and ceilings: clean	1
47. No unapproved private homes / living or sleeping quarters	1
SIGNS / REQUIREMENTS	
48. Last inspection report available	
49. Food Handler certifications available, current, and complete	1
50. Grade card and signs posted, visible	
COMPLIANCE AND ENFORCEMENT	
51. Plans approved / submitted	
52. Permit available / current	
53. Permit suspended / revoked	
54. Voluntary condemnation	1
55. Impound	



**FOOD ESTABLISHMENT INSPECTION FORM**

FACILITY NAME <b>CANTO DE LAS SIRENAS</b>	DATE <b>6/20/2019</b>	PERMIT # <b>PR0072176</b>
--	--------------------------	------------------------------

**1. FOOD SAFETY CERTIFICATION**

**POINTS**  
**0**

**Inspector Comments:** Proof of enrollment into an approved food manager certification course provided. Ensure certification is available in the facility within 30 days from test date (by 9-1-19).

**Violation Description:** Food facilities that prepare, handle or serve non-prepackaged potentially hazardous food, shall have an employee who has passed an approved food safety certification examination. Food safety certificate must be maintained at the food facility and made available for inspection. (113947.1 - 113947.5)

**9. PROPER COOLING METHODS**

**⚠ CRITICAL ⚠**

**POINTS**  
**4**

**Inspector Comments:** All potentially hazardous food shall be RAPIDLY cooled from 135°F to 70°F, within 2 hours, and then from 70°F to 41°F, within 4 hours. Cooling shall be by one or more of the following methods: in shallow containers; separating food into smaller portions; adding ice as an ingredient; using an ice bath, stirring frequently; using rapid cooling equipment; or using containers that facilitate heat transfer.

1. Observed the following internal temperatures: salsa 46.9F, and enchilada sauce 45.8F. Food had been cooked about 2.5 hours prior, and observed to be deep containers, stacked on top of each other, with lids. Ensure food is properly stored to prevent heat transfer (shallow containers, containers not stacked, etc.). Utilize ice bath in food preparation sink to properly cool these items.

2. Observed the following internal food temperatures of items cooked yesterday in deep containers with lids: salsa verde 47F, salsa 47F, salsa 54.4F. The following internal temperatures were observed for food in deep containers without lids, cooked yesterday: soup 45.4F, juice 45.3F, enchilada sauce 48.8F, and beans 49F. Observed the following internal temperatures of food items in containers about 4" deep, but double stacked, with lids: beans 45F, rice 45.7F and 45.6F, and cooked fish 45.3F.

3. Observed cheese shredded yesterday in deep plastic tub with lid, double stacked, at 47.2F. Ensure that cheese is promptly put in the refrigerator after shredding.

Follow above proper cooling methods. Reinspection for cooling may be conducted on or after 6-24-19. It is recommended to obtain a sheet pan rack and utilize sheet pans for cooling, to maximize cooling space in the walk-in. It is also recommended to cool food during business hours so that cooling temperatures can be monitored. Many food items in walk-in unit observed within approved temperature range. It is recommended to service walk-in refrigerator to ensure that all functions are working properly, such as defrost cycle, etc.

**Violation Description:** All potentially hazardous food shall be rapidly cooled from 135°F to 70°F within 2 hours, and then from 70°F to 41°F, within 4 hours. Cooling shall be by one or more of the following methods: in shallow containers; separating food into smaller portions; adding ice as an ingredient; using an ice bath, stirring frequently; using rapid cooling equipment; or, using containers that facilitate heat transfer. (114002, 114002.1)

**28. FOOD SEPARATED AND PROTECTED FROM CONTAMINATION**

**POINTS**  
**2**

**Inspector Comments:** All food shall be stored, prepared, displayed or held so that it is protected from contamination.

1. Clean interior of ice machine, as mold growth observed. Wash, rinse, and sanitize interior of ice machine.
2. Observed uncovered food in walk-in unit (beans, sauces, etc.). Provide food in storage to be covered.

**Violation Description:** All food shall be separated and protected from contamination. (113984, 113986, 114060, 114067(a, d, e), 114069(a, d), 114073, 114077, 114089.1(c), 114143(c))

**34. UTENSILS AND EQUIPMENT APPROVED, GOOD REPAIR**

**POINTS**  
**1**

**Inspector Comments:** All utensils and equipment shall be approved, properly installed, and in good repair.

1. Repair/replace rusted shelving in refrigeration units. Cover food in these units.
2. Repair/replace sprayer at warewash sink observed hanging into sink compartments.
3. Provide 1" minimum air gap between drain lines and floor sink near ice machine.

**Violation Description:** All utensils and equipment shall be approved and in good repair. (114130, 114130.1-114130.6, 114132, 114133, 114137, 114175, 114177, 114257)



**FOOD ESTABLISHMENT INSPECTION FORM**

FACILITY NAME <b>CANTO DE LAS SIRENAS</b>	DATE <b>6/20/2019</b>	PERMIT # <b>PR0072176</b>
--	--------------------------	------------------------------

**36. EQUIPMENT / UTENSILS PROPERLY INSTALLED, CLEAN; ADEQUATE CAPACITY**

**POINTS**

**1**

**Inspector Comments:** All equipment and utensils shall be kept clean and free of an accumulation of dust, dirt, food residue, and other debris.

Clean and maintain the following observed to be soiled: shelving throughout, hood (grease filters, fire suppression system, etc.), surfaces of cooking equipment, and walls (behind warewash sink).

**Violation Description:** All utensils and equipment shall be clean and installed in an approved manner. Equipment type and quantity shall be adequate for the operation. (114115, 114130.3, 114139, 114153, 114163, 114165, 114167, 114169, 114175, 114180, 114182, 114257)

**42. REFUSE PROPERLY DISPOSED: FACILITIES MAINTAINED**

**POINTS**

**0**

**Inspector Comments:** Maintain dumpsters covered when not in use.

Observed dumpsters lacking lids. Provide lids for dumpsters, and maintain lids closed.

**Violation Description:** All food waste and rubbish shall be kept in leakproof and rodent-proof containers. Containers shall be covered at all times. All waste must be removed and disposed of as frequently as necessary to prevent a nuisance. The exterior premises of each food facility shall be kept clean and free of litter and rubbish. (114244, 114245, 114245.1, 114245.2, 114245.3, 114245.4, 114245.5, 114245.6, 114245.7, 114257.1)

**49. FOOD HANDLER CERTIFICATIONS AVAILABLE, CURRENT, COMPLETE**

**POINTS**

**1**

**Inspector Comments:** All employees who handle food, utensils, or food equipment shall have a valid Riverside County Food Handler Certificate within one week of commencing work.

Observed 4 expired food handler cards. Replace these cards with approved cards.

**Violation Description:** County of Riverside Environmental Health Food Handler Certification(s) are available and current for all employees who prepare, store, or serve exposed food. (Riverside County Ordinance 567)

**54. VOLUNTARY CONDEMNATION**

**POINTS**

**0**

**Inspector Comments:** Food in violation #9 voluntarily discarded (except for food in category #1 cooked today) for improper cooling.

**Violation Description:** I, as the person in charge, hereby voluntarily agree to the condemnation and destruction of the food(s) listed in this report, said food(s) being alleged unfit for human consumption and in violation of California Health and Safety Code, Section 113980. I hereby release the County of Riverside, Department of Environmental Health and authorized agents from any and all responsibility.



County of Riverside  
DEPARTMENT OF ENVIRONMENTAL HEALTH  
www.rivcoeh.org

FOOD ESTABLISHMENT INSPECTION FORM

FACILITY NAME CANTO DE LAS SIRENAS	DATE 6/20/2019	PERMIT # PR0072176
---------------------------------------	-------------------	-----------------------

**Overall Inspection Comments**

Reinspection conducted due to downgrade of facility of 6-18-19 with score of 80=B. Facility has passed reinspection with score of 91=A. Correct remaining violations immediately. "B" card removed, "A" card posted.

**Did you know** that effective January 1, 2018, the California Health and Safety Code was amended to make it easier for food facilities to donate food? Please consider donating your excess food product to a local food bank, pantry, or soup kitchen. As a good faith food donor, you are protected from civil and criminal liability if the food product later causes harm to its recipient, unless the injury is a direct result of gross negligence or intentional misconduct in the preparation or handling of the donated food. See Section 171425 of the Civil Code and Sections 114432 to 114434 inclusive of the Health and Safety Code. For more information visit our website at [www.rivcoeh.org](http://www.rivcoeh.org).

**Signature**

\_\_\_\_\_  
Jose Arroyo  
Person in Charge  
06/20/2019

\_\_\_\_\_  
Marcie Craighead  
Environmental Health Specialist  
06/20/2019

## REASONS FOR IMMEDIATE CLOSURE OF A FOOD FACILITY

Per California Health and Safety Code Section 114409 (a):  
 "If any imminent health hazard is found, unless the hazard is immediately corrected, an enforcement officer may temporarily suspend the permit and order the food facility immediately closed."

A food facility may be closed for any of the following reasons:

- Overflowing sewage (inside or outside the facility)
- No potable water
- No hot water
- No electricity
- Rodent or insect infestation
- Any other conditions at the facility that may create an imminent public health risk

In addition to the reasons above, Per California Health and Safety Code Section 114411:

"The enforcement agency may, after providing opportunity for a hearing, modify, suspend, or revoke a permit for serious or repeated violations of any requirement of this part or for interference in the performance of the duty of the enforcement officer."

### PROPER FOOD STORAGE IN REFRIGERATORS AND FREEZERS

Ready-to-Eat Food

Cooked Food

Raw Meat, Raw Eggs

Store cooked and ready-to-eat food above raw food to avoid cross-contamination. Keep all food covered to prevent contamination.

## MANUAL SANITIZING OF EQUIPMENT AND UTENSILS USING A THREE COMPARTMENT SINK

1. **SCRAPE**, clean, or soak items as necessary before washing.
2. **WASH** items in detergent and hot water of at least 100°F in the first sink.
3. **RINSE** items in clear water in the second sink.
4. **SANITIZE** by submerging each item in a sanitizing solution in the third sink. Use one of the following sanitizing methods:
  - 100ppm of a chlorine based sanitizer for a minimum of 30 seconds in the solution
  - 200ppm of a quaternary ammonium based sanitizer for a minimum of 60 seconds in the solution
  - 25ppm of an iodine based sanitizer for a minimum of 60 seconds in the solution
  - Water at a temperature of 171°F for a minimum of 30 seconds in solution
5. **AIR DRY** all items on the drain board.

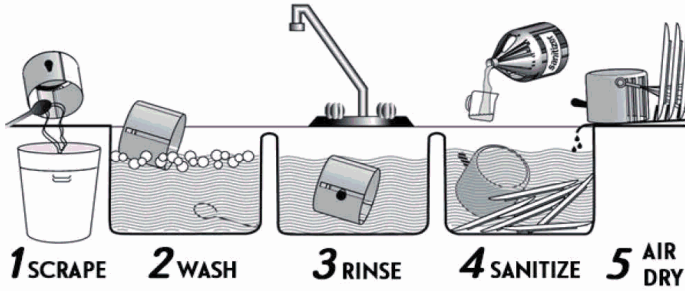

## PROPER COOLING OF FOOD IN YOUR FACILITY

Potentially hazardous foods should always be rapidly cooled.

### TIME IS THE KEY FACTOR IN PROPER COOLING

- Foods must cool from 135°F to 70°F in 2 hours or less
- Foods must cool from 70°F to 41°F in 4 hours or less

Use one of the following methods to cool food properly:

- Break large foods down into smaller portions and place in shallow pans no more than 4 inches deep. Metal pans cool better than glass or plastic pans.
- Add ice as an ingredient to replace water used in the recipe.
- Place foods within an ice bath and frequently stir the foods to speed the cooling process.
- Loosely cover foods so that heat and steam can escape during cooling.
- Arrange containers within a refrigeration unit so that air can flow properly around containers.
- Use special equipment like chill paddles or blast chillers to rapidly bring down food temperature.

Use an accurate thermometer to verify the food is being cooled within proper timeframes.

## PROPER FOOD THAWING METHODS

1. Under refrigeration
2. In a microwave oven on "defrost"
3. Submerged under cold running water in an approved preparation sink for no longer than 2 hours
4. As part of the cooking process

## INTERNAL COOKING TEMPERATURES

Use a probe thermometer to take internal cooking temperatures

<b>135°F</b> for 15 seconds	<b>145°F</b> for 15 seconds	<b>145°F</b> for 15 seconds	<b>145°F</b> for 15 seconds	<b>155°F</b> for 15 seconds	<b>155°F</b> for 15 seconds	<b>165°F</b> for 15 seconds	<b>165°F</b> for 15 seconds

Food temperature cannot be felt - use your probe thermometer!

### FOOD ALLERGENS

## THE MAJOR 8

## FOR QUESTIONS OR COMMENTS CONTACT YOUR LOCAL AREA OFFICE

<b>BLYTE</b> 260 N Broadway Blythe, CA 92225 Phone 760-921-5090 Fax 760-921-5085	<b>CORONA</b> 2275 S Main St #204 Corona, CA 92882 Phone 951-273-9140 Fax 951-520-8319	<b>HEMET</b> 800 S Sanderson Ave #200 Hemet, CA 92545 Phone 951-766-2824 Fax 951-766-7874	<b>INDIO</b> 47-950 Arabia St #A Indio, CA 92201 Phone 760-863-8287 Fax 760-863-8303	<b>MURRIETA</b> 30135 Technology Dr #250 Murrieta, CA 92563 Phone 951-461-0284 Fax 951-461-0245	<b>PALM SPRINGS</b> 554 S Paseo Dorotea Palm Springs, CA 92264 Phone 760-320-1048 Fax 760-320-1470	<b>RIVERSIDE</b> 4065 County Circle Dr #104 Riverside, CA 92503 Phone 951-358-5172 Fax 951-358-5017
--	--	---	--	---	--	---